

ABSOLUTE kit 231/EM

K231ABSOLUTE/EM

Assembled mesh back task chair, Kodi maxi nylon base, Lynx mechanism, Uber fixed seat, Zodiac adjustable arms

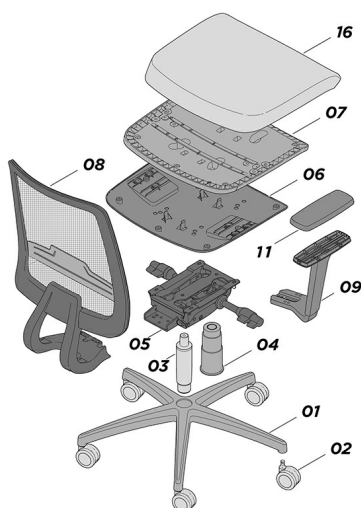

	CODE	DESCRIPTION	QUANTITY USED
1	BAY09101NR	KODI maxi base, Ø 700mm, nylon black	x 1
2	RUP0191NR	Free castor Ø 65mm, pin Ø 11mm, black	x 5
3	ALM41901	Tapered gas lift 50x28x210mm, class IV, run 125mm, black	x 1
4	STP009ANR	3 stages short telescopic bellow, Ø 50mm, black	x 1
5	SYM05413C	LYNX synchronized mechanism with tension control	x 1
6	SSP399ANR	UBER fixed seat outer, 10° armrests inclination, black	x 1
7	SDZ194AACAH	UBER reinforced seat for SSP399, 18 t-nuts	x 1
8	SEK548RNRNR	ABSOLUTE assembled backrest with black mesh and lumbar support, black plastic	x 1
9	BRY212AAHDNR	ZODIAC adjustable arm with integrated 10° bracket, right 2D, run 80mm, slide pad 58mm, black	x 1
10	BRY212AAHSNR	ZODIAC adjustable arm with integrated 10° bracket, left, 2D, run 80mm, slide pad 58mm, black	x 1
11	ACY184NR	ZODIAC nylon pad, black	x 2
12	VTM0516BPCFB	Hilo screw tip Ø10.5 truss head 5x16mm, bronzed	x 8
13	VTM0625BPCFB	Screw wide combo truss head M6x25mm, bronzed	x 4
14	VTM0640BPCFB	Screw wide combo truss head M6x40mm, bronzed	x 6
15	VTM0820BPBFB	Screw hex recess truss head M8x20mm, bronzed	x 3
16	* SDI192A	UBER seat foam	x 1
*: optional kit components			